

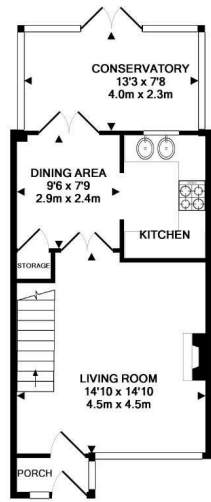

Keith  
Ashton

Lavender Avenue, Pilgrims Hatch  
Brentwood





GROUND FLOOR  
APPROX. FLOOR  
AREA 459 SQ. FT.  
(42.5 SQ. M.)

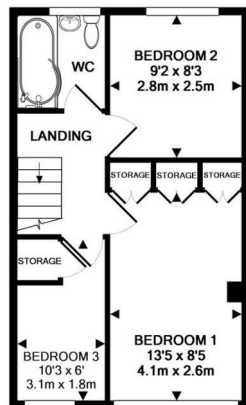

1ST FLOOR  
APPROX. FLOOR  
AREA 343 SQ. FT.  
(31.9 SQ. M.)



25 Lavender Avenue, Pilgrims Hatch, Brentwood, CM15 9PS

Situated on the sought after Flowers Development in Pilgrims Hatch, is this superbly presented three bedroom house. The property has been extended and comprehensively refurbished by the current owner and offers spacious accommodation comprising entrance porch, kitchen/dining area, fitted kitchen, three bedrooms and a luxury bathroom. Externally the property enjoys a good sized rear garden and a garage on block.

Lavender Avenue is situated within close proximity of great local schooling, local amenities and bus routes serving Brentwood's Town Centre and Mainline Station. An internal viewing is essential to appreciate the quality of the accommodation on offer.

Offers In Excess Of £365,000

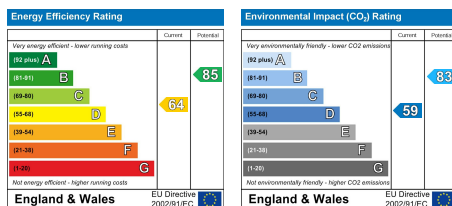

#### SERVICES:

Local Authority: Brentwood  
Council tax band: D  
Post code: CM15 9PS

#### VIEWING:

Strictly by prior arrangement with Keith Ashton Estate Agents

#### OPENING HOURS:

Monday to Friday: 8.45AM - 6.30PM | Saturdays: 9AM - 5.30PM | Sundays: 10AM - 2PM

#### MORTGAGE INFORMATION:

We offer the additional facility of an in-house Independent Financial Adviser who will access all mortgage lenders with the purpose of providing you with the benefit of choice. For quotations or comparables please call 01277 260858 or visit our interactive website at [www.mortgagebusiness.net](http://www.mortgagebusiness.net)



WE THE AGENT HAVE NOT TESTED ANY APPARATUS, FITTINGS OR SERVICES FOR THIS PROPERTY. THE PLOT SIZE IS INTENDED MERELY AS A GUIDE AND HAS NOT BEEN OFFICIALLY MEASURED OR VERIFIED BY THE AGENT. PHOTOGRAPHS ARE FOR ILLUSTRATION ONLY AND MAY DEPICT ITEMS WHICH ARE NOT FOR SALE OR INCLUDED IN THE SALE OF THE PROPERTY.

Brentwood  
Tel. 01277 260858

Village Office  
Tel. 01277 375757

Lettings Office  
Tel: 01277 202200

Explore more @ [www.keithashton.co.uk](http://www.keithashton.co.uk)

